

# GLASS SERIES

## IP66 POLYESTER WALL-MOUNTING CABINETS

Description: IP66 POLYESTER WALL-MOUNTING CABINET 500x400x200 OPAQUE DOOR

Reference:

**POL504020**

### Characteristics:

<b>Product type:</b>	Polyester wall-mounting cabinet
<b>Dimensions cabinet:</b>	(AxBxC) 500x400x200 mm
<b>Installation:</b>	Surface
<b>Type of door:</b>	Single opaque door
<b>Locking:</b>	Double-bit 3-mm DIN lock
<b>Finish:</b>	Double insulation: Class II
<b>Colour:</b>	RAL 7035
<b>Mounting plate:</b>	Without mounting plate
<b>Weight (kg):</b>	5,5
<b>Materials:</b>	Fibreglass-reinforced polyester
<b>Thickness:</b>	Enclosure 2,8 mm. Door 2,8 mm.
<b>Sealing gasket:</b>	Injected polyurethane sealing gasket
<b>Door material:</b>	Fibreglass-reinforced polyester
<b>Capacity:</b>	
<b>Max. cabinet load:</b>	40 kg
<b>Max. mounting plate load:</b>	33 kg
<b>Max. door load:</b>	6 kg

### Technical data:

<b>Degree of protection:</b>	IP66
<b>NEMA degree of protection:</b>	
<b>Resistance to impact:</b>	IK10
<b>Ambient temperature range:</b>	-30 °C / +60 °C
<b>Maximum operating voltage:</b>	1000 V AC / 1500 V DC

### Certificates and standards:

<b>Directive:</b>	2014/35/EU
<b>Standards:</b>	IEC 62208, IEC 61439-1
<b>Certificates:</b>	



### Codes:

<b>EAN:</b>	8431044292038
<b>Customs tariff number:</b>	85.38.10.00
<b>ETIM 8.0:</b>	EC000261

# GLASS SERIES

## IP66 POLYESTER WALL-MOUNTING CABINETS

Description: IP66 POLYESTER WALL-MOUNTING CABINET 500x400x200 OPAQUE DOOR

Reference: POL504020

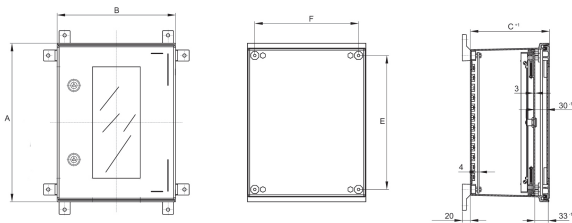

Standard drawing



**Detailed drawing:**  <http://www.ide.es/downloads/planos/pdf/POL504020.pdf>  
 <http://www.ide.es/downloads/planos/dxf/POL504020.dxf>  
 <http://www.ide.es/downloads/planos/stp/POL504020.stp>

<b>Cable entry:</b>	-	<b>Body to be flush-fitted:</b>	-
<b>Wall fixing:</b>	(ExF) 438x362 mm	<b>Wall fixing material:</b>	-
<b>Inside usable space:</b>	(Height x Width) 462x362 mm	<b>Glass door with transparent panel:</b>	-
<b>No. Hinges:</b>	2	<b>Door profiles:</b>	-

### Sustainability:

RoHS - REACH

### Supply:

Supplied in individual packaging. The accessories for fitting the mounting plate are fitted on the cabinet. Plate supplied in individual packaging if requested as an accessory.

### Product end of life:

It does not require specific recycling operations.

### Recommended applications:

Industrial environments and outdoor facilities. food, chemical and pharmaceutical industries, transformer sub-stations and outdoor areas where durability and resistance against chemicals and UV rays are necessary.